

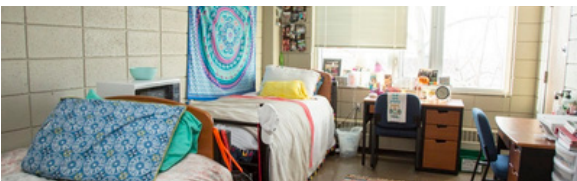

# UNIVERSITY OF CENTRAL MISSOURI HOUSING

## Fall 2026 | Move-In Emule #1



### WE ARE 8 WEEKS AWAY FROM MOVE-IN!

Welcome to UCM and University Housing! We are excited to see each one of you move into our halls in about 2 months! We take "Your Life Easier. Live on Campus" seriously and want to make the transition to UCM and life on campus as easy as possible. We want to provide information that will help with that transition and be knowledgeable as much as possible for move-in day!



### WELCOME FROM OUR SENIOR DIRECTOR

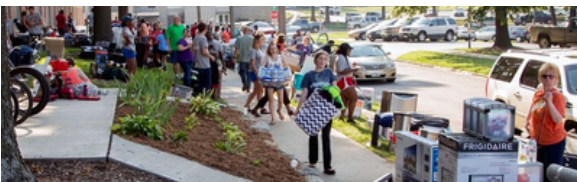

*Dr. Brenda Moeder  
Senior Director of  
University Housing*

The University Housing Residence Life Staff are looking forward to the fall semester and our UCM students joining us for their first time, their second, third, or fourth academic years. Lifelong friendships are often established with suitemates, floor and hall friends. We hope to provide you with that "Home Away from Home" family feeling. From the undergraduate staff members living with you on the floor, to senior administrators, they will do their best to help answer your questions about residence hall living and assist you with navigating our university and campus life. Enjoy the remainder of your summer. We will see you soon.

#### EXPLORE WHAT'S INSIDE THIS ISSUE:

- Welcome Housing Services
- Move-In Requirements
- Residence Hall Amenities
- Roommates/Suitemates
- Packing-List
- Registering Devices on Wifi
- Items to Leave at Home

## Follow UCM Housing



# HOUSING SERVICES

## Designed to Make Your Life Easier & Better

Prepping for life on campus or move-in can be a lot of work! University Housing and United Student Housing Association (USHA) provide a variety of optional services to make your life on campus more convenient including:



**Loft Rental** - Order your loft via College Products and pick up the unit on opening day. Cost for the year is \$145 before August 1 and \$165 after. If you want to loft your bed, this is the company you are required to rent from. Order at [collegeproducts.com/store/ucm](http://collegeproducts.com/store/ucm)



**Safe Purchase** - Purchase your safe from College products. Safes will be directly shipped to you so you can bring it on opening day. Cost of a safe is \$145. Order at [collegeproducts.com/store/ucm](http://collegeproducts.com/store/ucm)



**Linen & Room Essential Purchase** - Purchase bedding/other residence hall room essentials from On Campus Marketing. Proceeds benefit student programming and leadership engagement. Cost depends on the package you purchase. All packages are mailed to your home so you can bring them with you on opening day. Order at [ucmo.edu/housingservices](http://ucmo.edu/housingservices)



**Refrigerator and Microwave Rental** - Rent a refrigerator and/or microwave and pick it up on opening day. Fridge fee is \$70 for the year with a \$20 refund given upon return. Microwave fee is \$35 for the year with a \$15 refund given upon return. Feel free to bring your own but be sure they uses 1000 or less watts. Order form at [ucmo.edu/housingservices](http://ucmo.edu/housingservices)

Locate ordering forms and web ordering links at [ucmo.edu/housing](http://ucmo.edu/housing) under the Housing Services tab!

**NOTE:** This information is provided as a service. The University of Central Missouri does not require students or their families to purchase their bed linens or any other residence hall room supplies through the companies listed on this page or any other third party vendor.

# MOVE-IN REQUIREMENTS

You must have your Meningococcal (meningitis) immunization on record with the University Health Center before picking up your keys.

Learn more about how to submit your immunization records online  
[ucmo.edu/immunizations](http://ucmo.edu/immunizations)



Beat the move-in rush and be able to move in August 14th by signing up for the UCM Experience Kickoff. Feel extra prepared for your start at UCM by signing up!

Learn more by visiting:

[ucmo.edu/kickoff](http://ucmo.edu/kickoff)

# BATHROOM AMENITIES

Students must provide their own shower liners/curtains and hooks. Only the shower rod will be provided by UCM. Residence hall shower liner size; 72x72 inches.

### Amenities:

Sink / Tub/Shower  
Toilet  
Toiletries Basket  
Medicine Cabinet  
Towel Rods

**Note: Please do not use adhesive products (such as 3M strips) on any bathroom or shower wall.**





# Residence Hall Dimensions & Amenities

Residence Hall Diagram

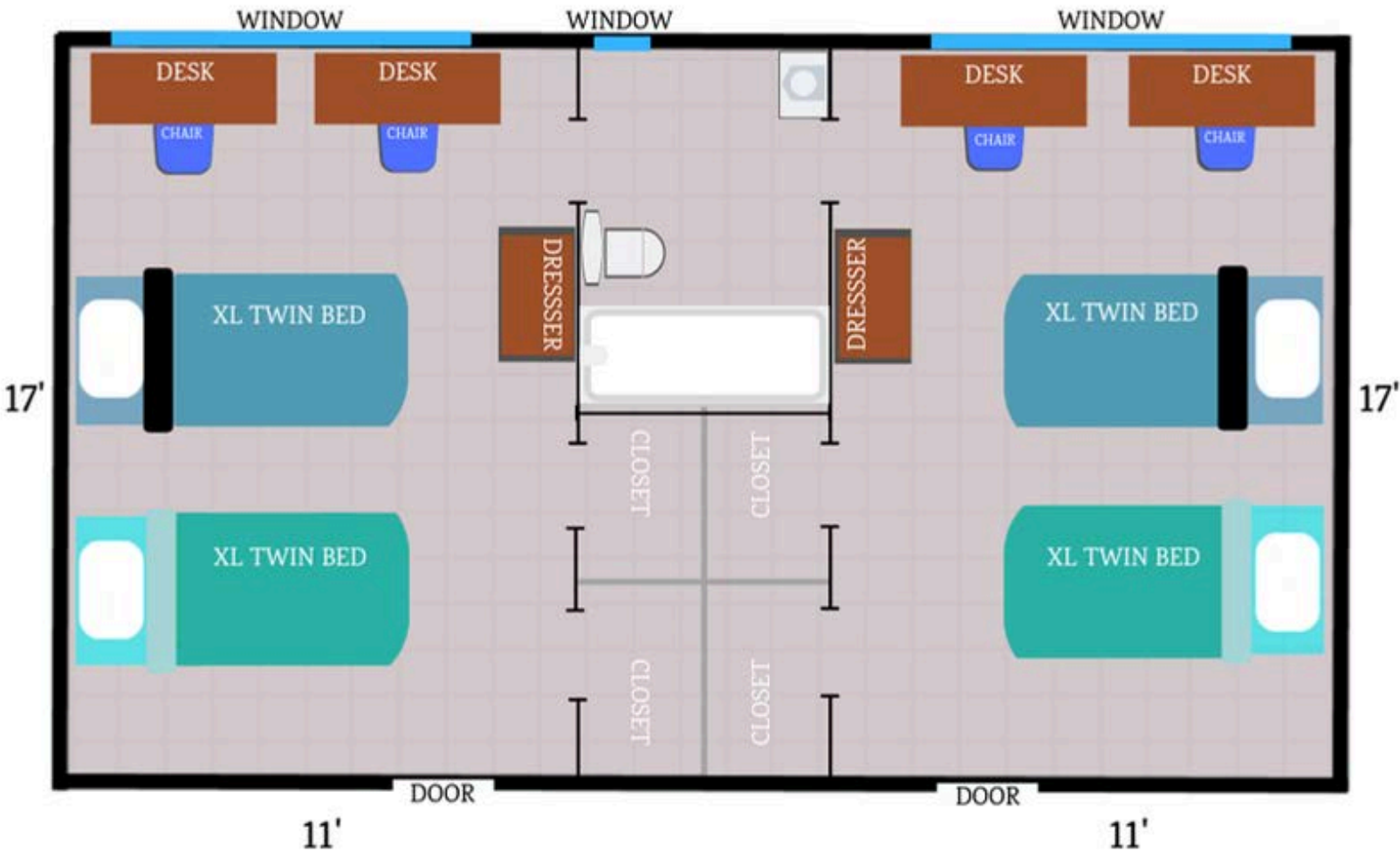

# UCM<sup>®</sup>

---

## HOUSING

### Residence Halls

# What's In My Room?

- Two Twin XL Beds & Mattresses
- One Dresser
- Two Desks & Chairs
- Trash Can/Recycle Bin
- Wifi/Ethernet
- Mini Blinds
- All Utilities

View More Info:

[ucmo.edu/movein](http://ucmo.edu/movein)



## Closets As Seen In: Ellis Complex

There are two closets with  
measurements as seen to the  
right

## Other Dimensions:

Windows: 5 Feet Tall X 7 Feet Wide

Storage Height Under Bed at highest  
setting: 33 Inches

Desktops: 4 ft x 2 ft

## Closet Measurements





Closets As Seen In:  
Fitzgerald

Other Dimensions:

Windows: 5 Feet Tall X 7 Feet  
Wide

Storage Height Under Bed at  
highest setting: 33 Inches

Desktops: 4 ft x 2 ft

## Closet Measurements





## Closets As Seen In: South Yeater and Panhellenic

There are two closets with  
measurments as seen to the right

## Other Dimensions:

Windows: 5 Feet Tall X 7 Feet Wide

Storage Height Under Bed at highest  
setting: 33 Inches

Desktops: 4 ft x 2 ft

## Closet Measurements





## Closets As Seen In: Houts/Hosey



### Other Dimensions:

Windows: 5 Feet Tall X 8 Feet Wide

Storage Height Under Bed at highest setting: 33 Inches

Desktops: 4 ft x 2 ft

## Closet Measurements





Closets As Seen In:  
Nickerson

\*3 total closets

Other Dimensions:

Windows: 5 Feet Tall X 7 Feet  
Wide

Storage Height Under Bed at  
highest setting: 33 Inches

Desktops: 4 ft x 2 ft

## Closet Measurements





# Other Commonly Asked Dimensions:

Storage area under bed:  
33 inches  
(adjustable to create more storage area)

Desktop Dimensions:  
4 feet x 2 feet

Dresser (non built-in) Dimensions  
4 feet tall x 2 feet wide

Mattress Dimensions  
Twin XL (Extra Long)  
38 inches x 80 inches

Window Dimensions:  
7 feet x 5 feet  
8 feet x 5 feet (Houts/Hosey)

**Visit**

**[ucmo.edu/residencehallliving](http://ucmo.edu/residencehallliving)**

**to explore each hall further!**

**Visit our Facebook for photo albums  
of each hall @ UCM Housing**



# ROOMMATES & SUITEMATES

## Establishing Great Relationships

Part of the on campus experience is having a roommate and/or suitemate. Creating relationships is vital as you start your UCM Journey. Find your roommate/ suitemate's information by logging onto the Housing Assignment Gateway in MyCentral under Student Records and Registration.



Your relationship with your roommate/suitemates is very important to your success at UCM. Students at UCM agree that getting in touch before you arrive takes pressure off the first day. You are encouraged to contact your suitemate to begin laying the groundwork.

Find out what TV shows, types of music, or activities your suitemate likes. Discuss class schedules, morning routines, and cleaning of the bathrooms! Remember, we are all unique and different in our backgrounds, values, and attitudes.

All students will get a resource sheet on recommended bathroom cleaning.

Roommate agreements are required and we also have suitemate agreements as a resource.

## MOVE-IN DAY: REQUIRED SIGN UP

As you plan for move-in, please know we will not be restricting guest numbers this year, however, we do require that only the student enter at first to obtain their key. Once their key is picked up, all guests may enter and assist. We appreciate the cooperation as we keep our lobbies/curbsides less congested. Students will be emailed their link to sign up for a check-in time. This will be sent out in mid/late July.

### Move In Dates/Times:

#### Thursday, August 13:

9 am - 3 pm (First Year Students who signed up for the UCM Kickoff Experience)

#### Friday, August 14:

10 am - 4 pm (The Crossing)

10 am - 4 pm (Foster-Knox Apartments, Todd Apartments, Nickerson Apartments)

9 am - 4 pm (Central Village and Greenwood Park) \*Check in at Housing office in Ellis

#### Saturday, August 15:

2 pm - 5 pm (The Crossing, Foster-Knox Apartments, Todd Apartments, Nickerson Apartments)

#### Sunday, August 16:

10 am - 3 pm (All returning students moving into residence halls and first-year students who did not sign up for UCM Experience Kickoff)

10 am - 2 pm (The Crossing, Foster-Knox Apartments, Todd Apartments, Nickerson Apartments)

9 am - 3 pm (Central Village and Greenwood Park, check-in at the Housing office)

## APPROVED FOR EARLY

## MOVE-IN?

Because of security & logistical reasons, you will not have access to your room until you check in during the designated times.

Some groups will have a coordinated early arrival (staff, pre-season athletics, etc.); those students will be contacted by the group coordinator regarding check in times.





# UCM Residence Hall Packing List

## Bedding & Bath

Twin XL mattress pad  
Twin XL comforter and sheets  
Standard pillow and pillow cases  
Blanket  
Bath mat  
Shower liner (72"x72") and hooks  
Towels and wash cloths  
Shower shoes / Flip flops  
Shower caddy  
Soap / Shampoo / Conditioner  
Hair products / Hair dryer  
Make-up / Moisturizers  
Toothbrush / Toothpaste  
Shaving accessories  
Medications / Supplements  
Toilet paper  
First-Aid kit

## Laundry & Cleaning

Detergents -- High Efficiency (HE) only  
Dryer sheets  
Stain remover and fabric softener  
Iron / Steamer (with auto shut-off)  
Ironing board  
Laundry hamper / basket  
Paper towels  
Broom / vacuum  
Trash can liners (8 gal.) -- trash can included  
Cleaning soap, sprays, and sponges

## Style & Decor

Posters / Keepsakes / Photos  
Wall decals and frames  
Wall calendar  
Small corkboard / Dry-erase board  
3M Command adhesive products  
Futon\*

## Electronics & Appliances

Microwave (1000 watts or less)\*  
Mini-fridge (1000 watts and 6.0 cubic feet or less)\*  
Floor fan / Clip-on fan  
Computer with ethernet/WIFI capability  
Alarm clock  
External hard drive  
Power strip with surge protector (including 10+ ft. power strip to reach all areas of room)  
Chargers for electronics  
Ethernet cable (and ethernet splitter)  
Printer  
TV (can register for WiFi connection)  
Batteries

## Storage & Lighting

Ottoman / Cubes  
Storage bins  
Hangers  
Desk lamp / Floor lamp

## Identification & Valuables

ATM card and checkbook  
Drivers license / ID  
Passport / Visa  
Social security card / Birth certificate  
Lock box / Safe\*  
Lanyard / Key wallet

## School Supplies

Backpack  
Calculator  
Planner  
Notebooks / Binders  
Pens / Pencils / Highlighters  
Scissors  
Stapler  
Tape / Sticky-Notes  
Printer paper

# YOUR CAMPUS. YOUR HOME.



## WIFI, ETHERNET & STREAMING

UCM no longer provides cable within the residence halls or apartments. However, the Office of Technology has created a process for students to register various devices if students wish to stream their favorite shows, movies, or play their favorite video games.

Rooms and commons areas have wifi and within rooms you will find an ethernet port. If you and your roommate both plan to use ethernet for any reason, a splitter would be required.

Please note that personal routers are not allowed on campus as they interfere with the university's network. Helpful information regarding getting the most out of your WiFi signal can be found on the Technology Support Center page.

***Register devices at [student.devices.ucmo.edu](http://student.devices.ucmo.edu)***

Students are allowed to register 3 devices. Devices that can connect wireless include various game systems, smart TVs, streaming devices (such as Roku, Firestick, etc).

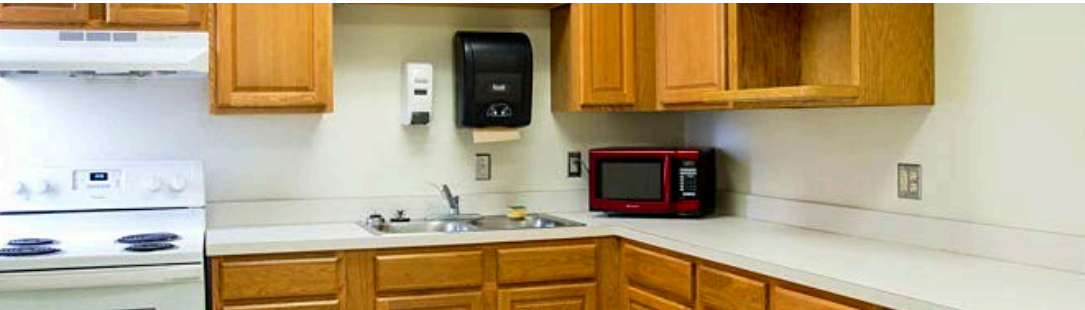

## ITEMS TO LEAVE AT HOME

***A Community That is Safety Conscious***

When students live in close proximity, poor decisions or careless choices can significantly impact on the safety of others. For this reason, we are very restrictive with personal items that could pose a risk to others or that pose even a small risk of fire. This includes prohibited items including:

- Scented wax cube warmers
- Candles/Incense (no burnt wicks allowed)
- Hoverboards/Electric scooters
- Halogen lamps/lava lamps
- Weapons (as defined in Guide to Good Decision Making)
- Outdoor grills
- Hot plates
- Toaster ovens
- Space Heaters

Appliances allowed for use in student rooms:

Coffee Makers  
Microwaves

Other appliances must be used in community kitchen and must NEVER be left unattended

## IMPORTANT DATES

AUGUST

13th: Freshmen signed up for UCM Experience Kickoff move in 9 am - 3 pm

14th: University Apartments open

16th: Freshmen not signed up for UCM Experience Kickoff and upperclass students move in 10 am - 3 pm

17th: Classes begin

21st: Last day to change your meal plan



## CONTACT US!

University Housing  
Ellis Complex L23  
Warrensburg, MO 64093

Phone: 660-543-4515  
[housing@ucmo.edu](mailto:housing@ucmo.edu)  
[ucmo.edu/housing](http://ucmo.edu/housing)  
[@UCMHousing](https://www.instagram.com/UCMHousing)

## IN THE NEXT ISSUE:

- Meal plans
- Decorating your new home
- Textcaster
- Housing Policies
- Textbook pickup
- Resources